

# DuPont™ Thermax™ Light Duty Insulation in Tilt-Up Concrete Walls

## Installation Recommendations

### SYSTEM OVERVIEW

#### General Information

DuPont™ Thermax™ Light Duty Insulation\*, when installed on the interior of tilt-up concrete walls, enhances the building’s thermal performance and moisture management and helps meet continuous insulation requirements mandated by energy efficiency codes and standards, such as IECC and ASHRAE 90.1.\*\* Thermax™ Light Duty can be installed exposed to the interior without a thermal barrier.

Thermax™ Light Duty is lightweight and easy to install, and can be adhered directly to concrete or masonry walls. It consists of a glass-fiber-reinforced polyisocyanurate foam core laminated with a 1.25 mil embossed white acrylic-coated aluminum facer on one side and 1.25 mil embossed aluminum on the other side. The facers make it a durable choice for use in light-impact areas. It can be pressure-washed up to 1,000 psi with a 15-degree or greater spray tip (at minimum 3’ distance).

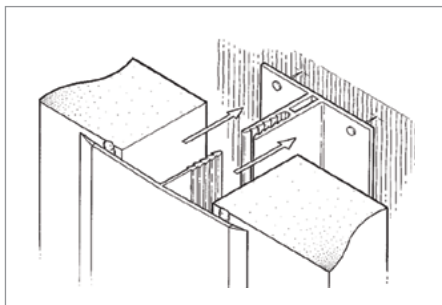

Figure 1

#### Materials Checklist

- Thermax™ Light Duty Insulation (code-approved thickness at minimum)
- Utility knife or small handsaw
- Straight edge
- Measuring tape
- Pencil
- Pneumatic nailer (or equivalent)
- PVC (polyvinyl chloride) interlocking system (Figure 1)
- Self-impaling nails/fasteners and 1.25” diameter (min.) plastic washers
- Construction-grade adhesive
- Silicone, polyurethane or butyl sealant (Table 1)
- Safety glasses

TABLE 1: Recommended Sealants for Use with Thermax™ Light Duty Insulation

Material	Recommended Sealant
Silicone	Dow Corning 790 Silicone Building Sealant
Polyurethane	Sika Sikaflex-201 US Polyurethane Sealant
Polyurethane	Schnee-Morehead Permathane SM7108 Polyurethane Sealant
Butyl	Tremco Vulkem 116 Sealant

### INSTALLATION

#### Insulation Boards

1. Install Thermax™ Light Duty Insulation boards along the bottom perimeter of the interior walls by applying a 3/8” bead on the back side of boards at 5’ horizontally.
2. Apply a 3/8” bead of polyurethane or butyl caulk to the top of each board and around each cut penetration (joist pockets, conduits, cutouts, etc.).
3. Install PVC interlocking system vertically with self-impaling nails/ fasteners and washers (Figure 1).

4. Fasten nails/fasteners and washers through front face of insulation board at 5’ o.c. vertically.
5. Apply a 3/8” bead of sealant to the bottom flange of all J-Channel molding (Figure 2).

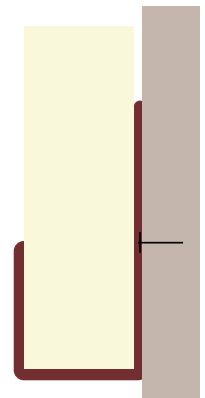

Figure 2

\* Thermax™ Light Duty Insulation is a former product of The Dow Chemical Company.

\*\* International Energy Conservation Code (IECC) at [www.energycodes.gov](http://www.energycodes.gov) and American Society of Heating, Refrigerating and Air-Conditioning Engineers at [www.ashrae.org](http://www.ashrae.org)

## Remaining Wall Area

1. Fasten base section of PVC interlocking system to concrete or masonry wall through holes provided at 12" o.c. with pneumatic nailer or equivalent.
2. Adjust base strip to insulation board to allow for correct width. Align each PVC section 1/8" from the insulation board, mark and attach.
3. Apply beads of construction-grade adhesive to the concrete centered 16" o.c. between the PVC strips.
4. Press boards firmly into position between the base strips. Allow curing time according to adhesive manufacturer's recommendation.
5. Apply a continuous bead of sealant along the face of the boards next to the joint.
6. Guide the top PVC section along the insulation board until it snaps into the interlocking system base (Figure 3).

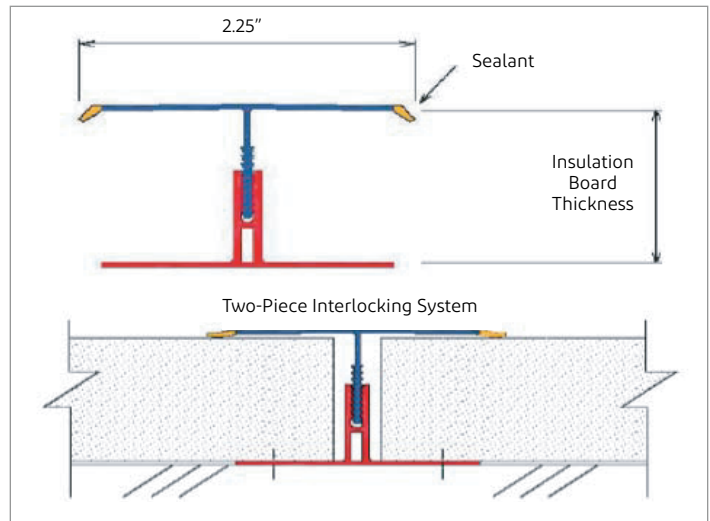

Figure 3

## Exposure & Storage Information

- Store insulation inside or protect with a tarp to keep dry until use. Prolonged exposure to water or moisture may discolor the surface.
- Minor scratches and/or nicks may occur during installation. Also, the edges of the foil facer may become slightly curled. This does not affect the product's overall performance.
- A coat of good quality latex acrylic or latex enamel paint can be used to touch up the boards, and no primer is required. Follow paint manufacturer's recommendations for best results.
- There are two ways to cut **DuPont™ Thermax™ Light Duty Insulation**: use a straight edge and a utility knife to cut all the way through the facing, or cut with a small handsaw.



For more information visit  
[thermaxwallsystem.com](http://thermaxwallsystem.com)  
or call 1-866-583-2583

**NOTICE:** No freedom from any patent owned by DuPont or others is to be inferred. Because use conditions and applicable laws may differ from one location to another and may change with time, Customer is responsible for determining whether products and the information in this document are appropriate for Customer's use and for ensuring that Customer's workplace and disposal practices are in compliance with applicable laws and other government enactments. The product shown in this literature may not be available for sale and/or available in all geographies where DuPont is represented. The claims made may not have been approved for use in all countries or regions. DuPont assumes no obligation or liability for the information in this document. References to "DuPont" or the "Company" mean the DuPont legal entity selling the products to Customer unless otherwise expressly noted. NO EXPRESS WARRANTIES ARE GIVEN EXCEPT FOR ANY APPLICABLE WRITTEN WARRANTIES SPECIFICALLY PROVIDED BY DUPONT. ALL IMPLIED WARRANTIES INCLUDING THOSE OF MERCHANTABILITY AND FITNESS FOR A PARTICULAR PURPOSE ARE EXPRESSLY EXCLUDED. The buyer assumes all risks as to the use of the material. Buyer's exclusive remedy or any claim (including without limitations, negligence, strict liability, or tort) shall be limited to the refund of the purchase price of the material. Failure to strictly adhere to any recommended procedures shall release DuPont Specialty Products USA, LLC or its affiliates, of all liability with respect to the materials or the use thereof. The information herein is not intended for use by non-professional designers, applicators or other persons who do not purchase or utilize this product in the normal course of their business.

**CAUTION:** When cured, these products are combustible and will burn if exposed to open flame or sparks from high-energy sources. Do not expose to temperatures above 240°F (116°C). For more information, consult (Material) Safety Data Sheet ((M)SDS), call DuPont at 1-866-583-BLUE (2583) or contact your local building inspector. In an emergency, call 1-989-636-4400 in the U.S. or 1-519-339-3711 in Canada. The blowing agent contained within this product can exhibit vapor flame limits under the right conditions. If specific operating conditions are such that concentrations of the blowing agent above the lower flammable limit can accumulate in areas with high relative humidity and in the presence of high-energy electrical discharges or other ignition sources, additional measures such as increased ventilation or coded electrical equipment (class one, division two) may be warranted. DO NOT SMOKE DURING USE. DO NOT USE NEAR ANY OPEN FLAME OR ELECTRICAL SOURCE. OUTDOOR USE ONLY. INDOOR USE INCREASES LIKELIHOOD OF IGNITABLE CONDITIONS. INSTASTIK™ Quik Set Commercial Roofing Adhesive contains isocyanate and a blowing agent. Read the label and (Material) Safety Data Sheet ((M)SDS) carefully before use. Wear gloves, and goggles or safety glasses. Provide adequate ventilation or wear proper respiratory protection. Contents under pressure. For outside use only.

Thermax products should be used only in strict accordance with product application instructions. Thermax products, when used in a building containing combustible materials, may contribute to the spread of fire. For more information, consult MSDS and/or call DuPont at 1-866-583-2583.

**WARNING:** Thermax insulation does not constitute a working walkable surface or qualify as a fall protection product.

Building and/or construction practices unrelated to insulation could greatly affect moisture and the potential for mold formation. No material supplier including DuPont can give assurance that mold will not develop in any specific system.

DuPont™, the DuPont Oval Logo, and all trademarks and service marks denoted with ™, SM or ® are owned by affiliates of DuPont de Nemours, Inc. unless otherwise noted. © 2019 DuPont.